

FLAT DOOR SYSTEM
WITH THERMAL BREAK

ETEM

E75 IS A SYSTEM CORRESPONDING TO THE MOST MODERN REQUIREMENTS OF THERMAL INSULATION, FUNCTIONALITY AND AESTHETICS

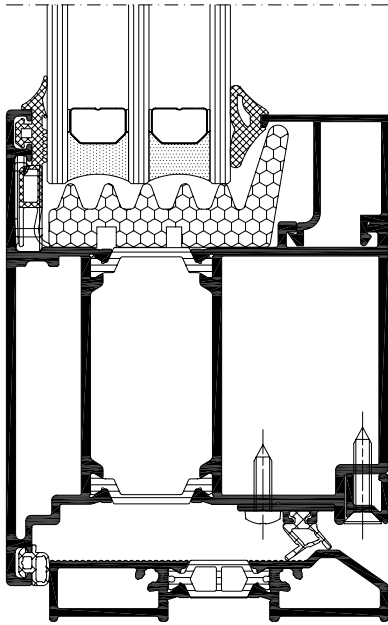

FEATURES

$U_w = 1,27 \text{ W/m}^2\text{K}$

Additional insulator under the glass

Additional insulator in the thermal break chamber

Straight design

Highest structural stability

Multi point locking possibility

Solution with hidden hinges

E75

FLAT DOOR
SYSTEM WITH
THERMAL BREAK

DESIGN

VARIOUS SOLUTIONS FOR FLOOR
FINISH- BOTTOM PROFILES AND
THRESHOLDS

SECURITY

POSSIBILITY OF MOUNTING ANTI-
BURGLAR HARDWARE FOR BETTER
SECURITY PERFORMANCE

EFFICIENCY

EXTRUDED CORNERS FOR CRIMPING
MACHINE ALLOWING BETTER
CONNECTIONS AND REDUCED
ASSEMBLY TIME

DETAILS

Excellent thermal insulation

Elegant straight design - 75 mm system width

Additional insulator in the thermal break chamber

Highest structural stability

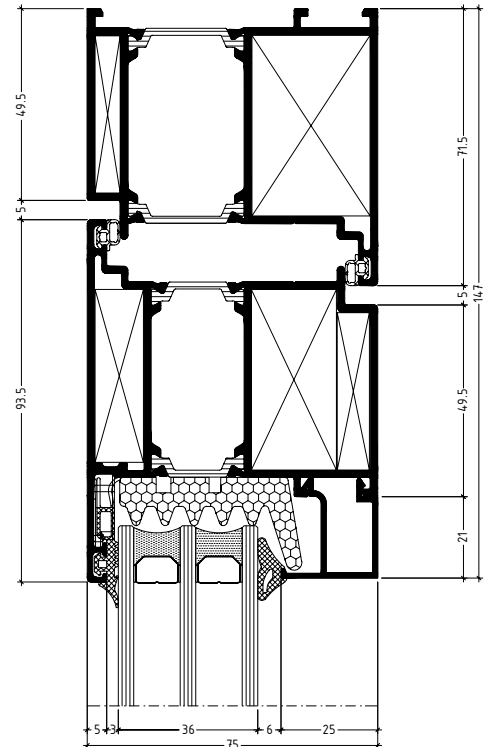

etem.com